

Entrance Handles



SABRE

ARCHITECTURAL

As a brand, Sabre Hardware has been a part of the architectural construction supply landscape for over 40 years. Originally launched by Specialty Hardware in Sydney, Sabre became part of the family-owned Access Hardware Group in 2010, facilitating more product investment and development to meet changing market demands.

Our strategic partnerships with manufacturers in the United States, China, Taiwan and Australia have been a cornerstone of our ability to meet customer needs. We will continue to invest in these partnerships to deliver on our mission statement; to always strive to offer quality hardware solutions at the right price. Before a product is branded Sabre, it is rigorously tested to ensure it meets market expectations.

The Sabre product range covers common product categories such as door controls, locksets, entrance handles, general hardware and commercial washroom equipment. Sabre branded products are dispatched daily to all states and territories around Australia.



5 Year Mechanical Warranty



AS1428.1 Compliant



Made from 304 Stainless Steel

Entrance Handles

Entrance Handles

Entrance Handle Accessories

ENTRANCE HANDLES

SUITABLE FOR TIMBER, ALUMINIUM AND GLASS DOORS

The Sabre range of Entrance Handles are ideal for making those first impressions last. Made from durable and corrosion resistant 304 stainless steel material, there is sure to be one that suits your requirements.

Most designs are available in various sizes and come complete with all relevant fixing screws to suit your application. Special fixing options are also available to suit single sided fixing solutions.

Note: All handle sets come complete with 2 x 100mm, 2 x 50mm M8 bolts and protective washers to suit.

- Constructed from quality 304 stainless steel
- Back to back fixing as standard (other options available)
- Suitable for timber and aluminium doors up to 50mm thick
- Suitable for glass doors between 10-12mm thick
- Suitable for commercial and industrial applications
- 12mm diameter hole for glass installation

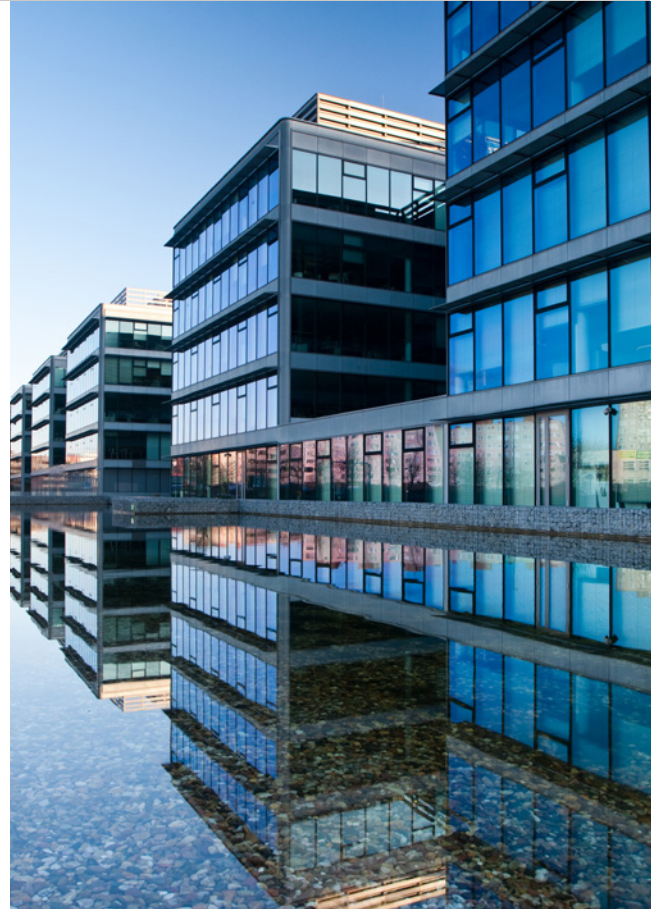

1141 Oval Entrance Handle



CODE

SAB-EH1141-750

FINISH

SSS - Satin Stainless Steel

DETAILS

- 25mm x 25mm stand off section
- 44mm finger clearance

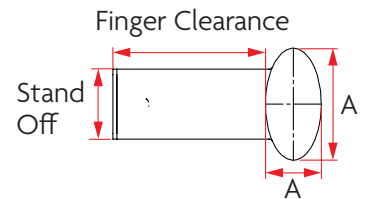
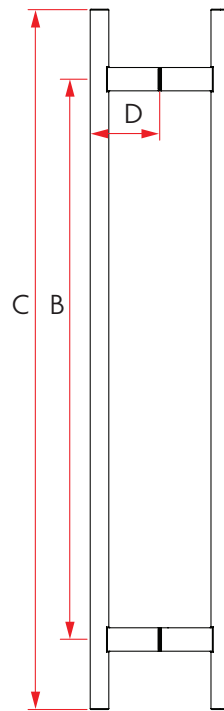

Code	Section (A)	Centres (B)	OA Length (C)	Projection (D)
SAB-EH1141-750	40 x 20mm	600mm	750mm	64mm

ENTRANCE HANDLES

1145 Square Entrance Handle

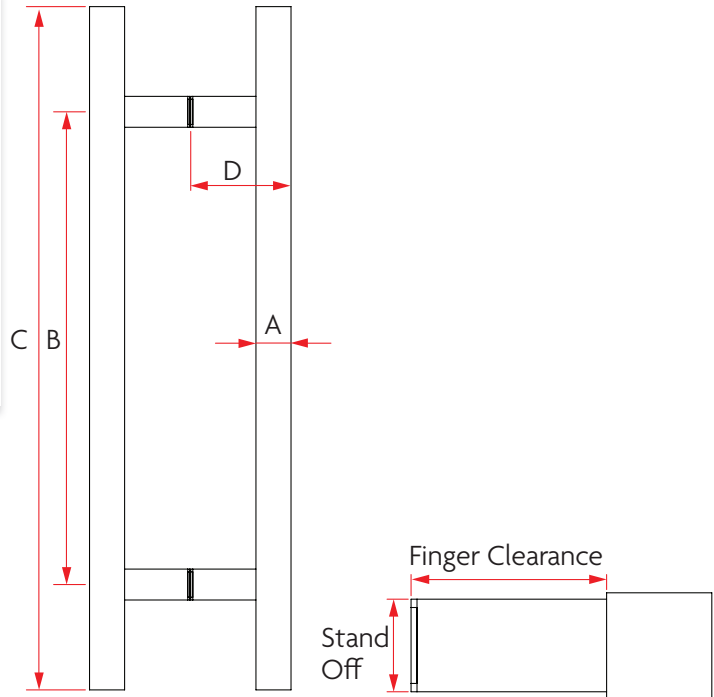

CODE

SAB-EH1145-450
SAB-EH1145-600

FINISH

SSS - Satin Stainless Steel

DETAILS

- 22mm x 22mm stand off section
- 44mm finger clearance

Code	Section (A)	Centres (B)	OA Length (C)	Projection (D)
SAB-EH1145-450	25 x 25mm	300mm	450mm	69mm
SAB-EH1145-600	25 x 25mm	450mm	600mm	69mm

1151 Round Entrance Handle

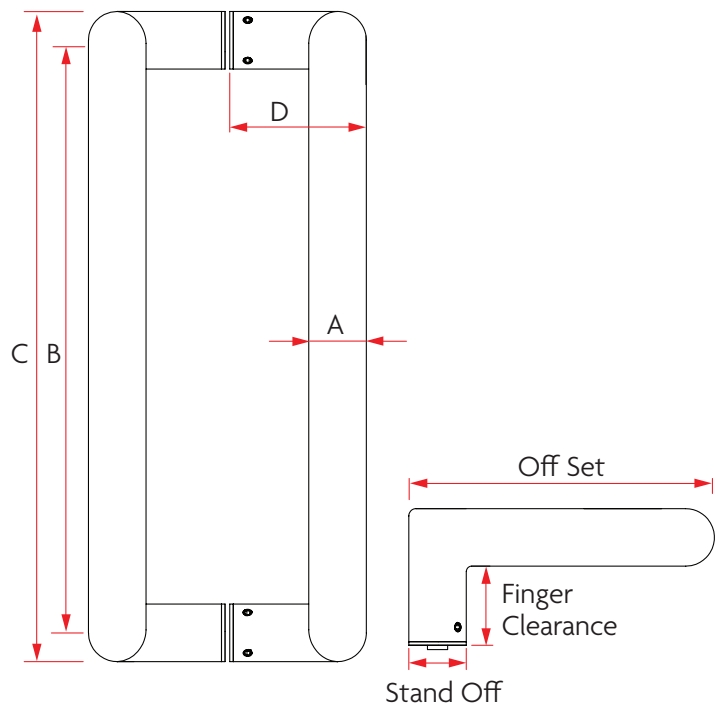

CODE

SAB-EH1151-300

FINISH

SSS - Satin Stainless Steel

DETAILS

- 120mm off set
- 44mm finger clearance
- Radius mitre joint to reduce potential injury

Code	Section (A)	Centres (B)	OA Length (C)	Projection (D)
SAB-EH1151-300	32mm	300m	332mm	76mm

ENTRANCE HANDLES

1192 Round Entrance Handle



CODE

SAB-EH1192-600

FINISH

SSS - Satin Stainless Steel

DETAILS

- 130mm off set
- 55mm finger clearance

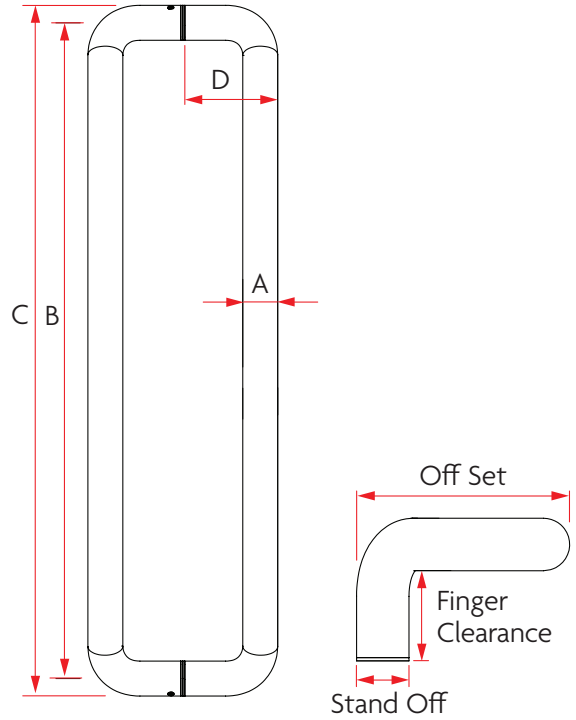

Code	Section (A)	Centres (B)	OA Length (C)	Projection (D)
SAB-EH1192-600	32mm	600mm	632mm	87mm

1195 Round Entrance Handle



CODE

SAB-EH1195-450
SAB-EH1195-600

FINISH

SSS - Satin Stainless Steel

DETAILS

- 25mm diameter stand off section
- 44mm finger clearance

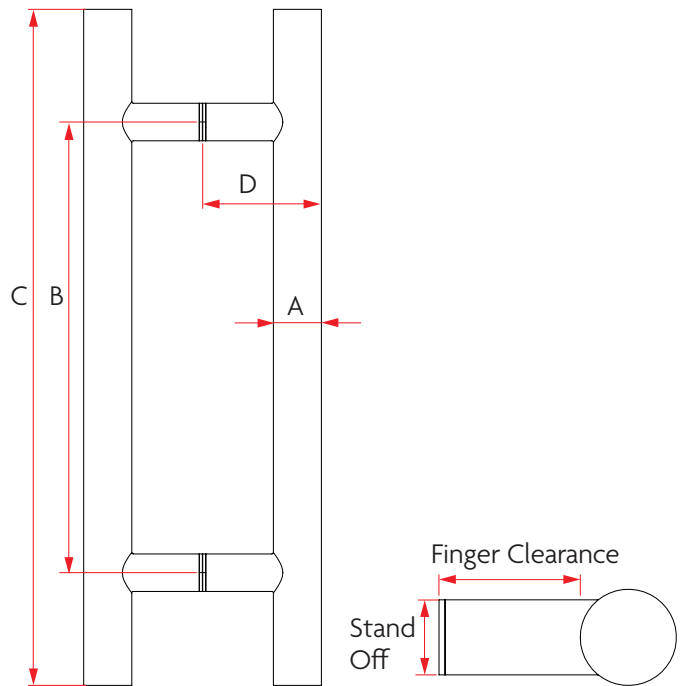

Code	Section (A)	Centres (B)	OA Length (C)	Projection (D)
SAB-EH1195-450	32mm	300mm	450mm	76mm
SAB-EH1195-600	32mm	450mm	600mm	76mm

ENTRANCE HANDLES

1213 Rectangular Entrance Handle



CODE

SAB-EH1213-450
SAB-EH1213-600

FINISH

SSS - Satin Stainless Steel

DETAILS

37mm finger clearance

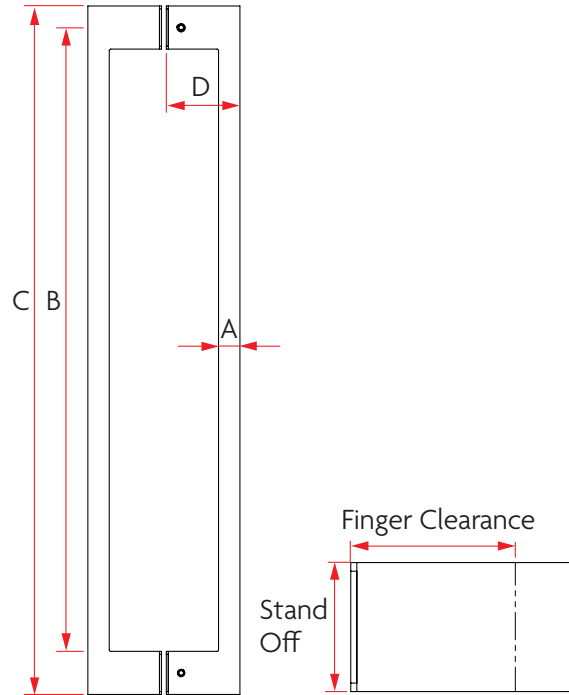

Code	Section (A)	Centres (B)	OA Length (C)	Projection (D)
SAB-EH1213-450	30 x 15mm	450mm	480mm	52mm
SAB-EH1213-600	30 x 15mm	600mm	630mm	52mm

1222 Round Entrance Handle



CODE

SAB-EH1222-300
SAB-EH1222-600

FINISH

SSS - Satin Stainless Steel

DETAILS

55mm finger clearance

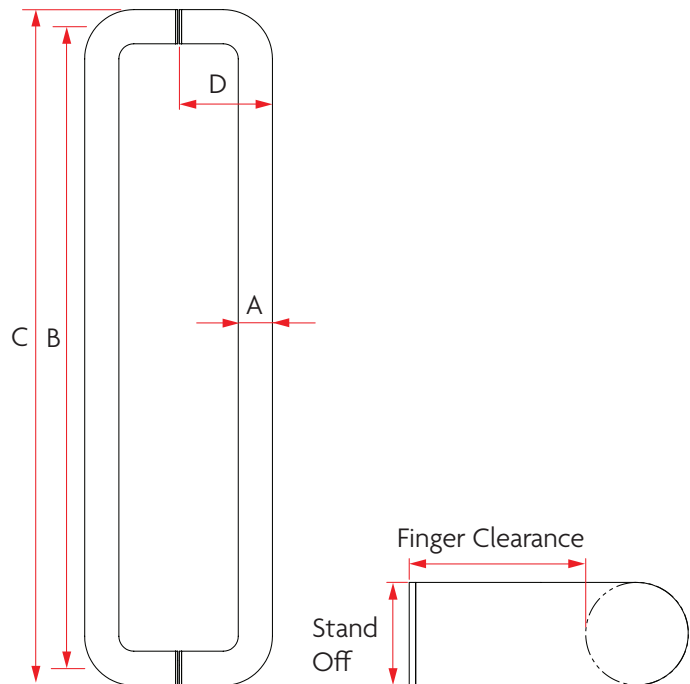

Code	Section (A)	Centres (B)	OA Length (C)	Projection (D)
SAB-EH1222-300	32mm	300mm	332mm	87mm
SAB-EH1222-600	32mm	600mm	632mm	87mm

ENTRANCE HANDLES

1231 Round Entrance Handle



CODE

SAB-EH1231-300
SAB-EH1231-600

FINISH

SSS - Satin Stainless Steel

DETAILS

- 140mm off set
- 50mm finger clearance

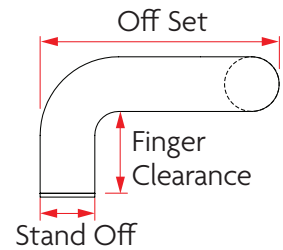
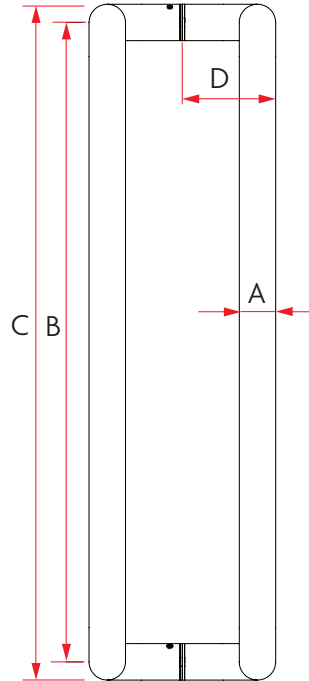

Code	Section (A)	Centres (B)	OA Length (C)	Projection (D)
SAB-EH1231-300	32mm	300mm	332mm	82mm
SAB-EH1231-600	32mm	600mm	632mm	82mm

1233 Square Entrance Handle



CODE

SAB-EH1233-300

FINISH

SSS - Satin Stainless Steel

DETAILS

- 60mm off set
- 37mm finger clearance

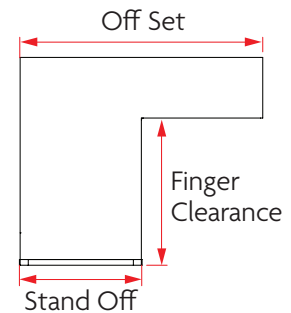
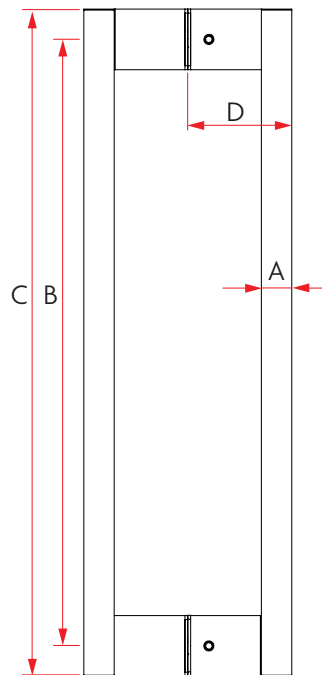

Code	Section (A)	Centres (B)	OA Length (C)	Projection (D)
SAB-EH1233-300	30 x 30 x 15mm	300mm	330mm	52mm

1244 Square Entrance Handle



CODE

SAB-EH1244-300
SAB-EH1244-450
SAB-EH1244-600

FINISH

SSS - Satin Stainless Steel
BLK - Black*

DETAILS

- 85mm off set
- 37mm finger clearance
- * 600mm only

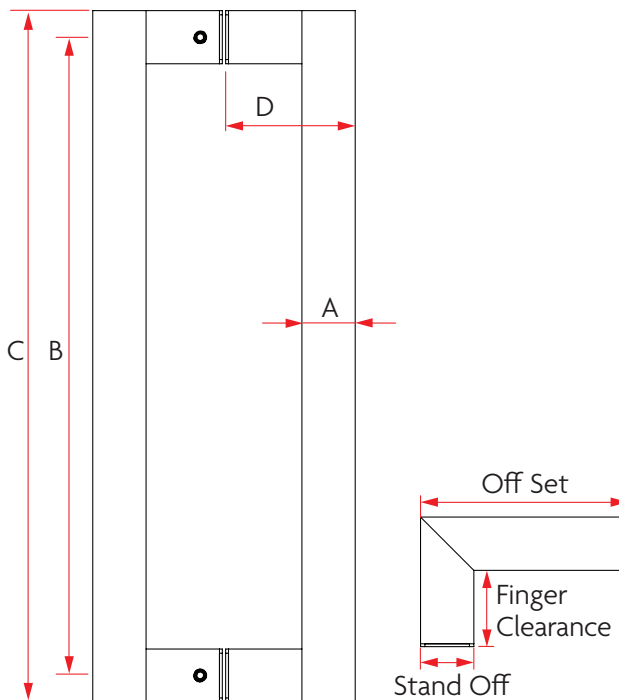

Code	Section (A)	Centres (B)	OA Length (C)	Projection (D)
SAB-EH1244-300	25 x 25mm	300mm	325mm	62mm
SAB-EH1244-450	25 x 25mm	450mm	475mm	62mm
SAB-EH1244-600	25 x 25mm	600mm	625mm	62mm

ENTRANCE HANDLE ACCESSORIES

Single Side - External Portion Fixing Kits

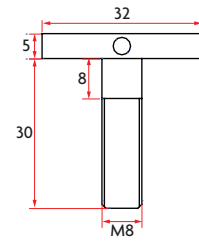
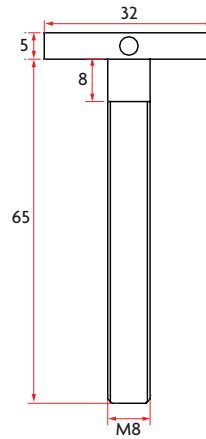

CODE

SAB-EH-EXT-GLASS (30mm)

SAB-EH-EXT-TIMBER (65mm)

FINISH

SSS - Satin Stainless Steel

DETAILS

- 30mm version suitable for glass doors
- 65mm version suitable for timber and aluminium doors
- Both versions are for use with external portions of back to back entrance handle set

Single Side - Internal Portion Fixing Kits

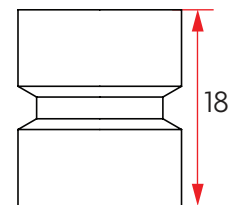
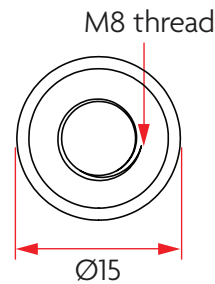

CODE

SAB-EH-INT-M8-BRASS

FINISH

Brass

DETAILS

- For use with internal portion of back to back entrance handle set.

Note: This will need to be combined with a suitable external portion fixing kit.

NOTES

